

BOX BD PLUS 9/9 M6 0,13kW (251280451)

GENERAL DATA



CENTRIFUGAL FAN IN SOUNDPROOF BOX WITH SANDWICH PANELS

MANUFACTURING FEATURES

- Impellers made of polyamide reinforced with fibreglass.
- BD range fans assembled in soundproof cabinets.
- Ventilation box with 30 mm aluminum profile structure, nylon corners, galvanized sandwich panels with internal insulation rockwool (25mm thickness) class A1 (non-combustible) of 90kg/m³ density. All panels are equipped with "fastening system" for the quick assembly and disassembly whenever required, either for cleaning, maintenance or exchanging of panels.
- Connection gland included.
- Easy access through lateral panel.
- Fan can be placed in any position by exchanging panels.
- Closed motors specially designed by Casals. Extruded aluminium motor housing. Totally enclosed terminal box on the motor IP 65 protection and motor with IP54 protection and Class F insulation. Standard voltages 230V 50Hz for single phase and 230/400V 50Hz for three phase motors.

APPLICATIONS

Designed for inline installation, indoor or outdoor assembly, they are suitable for:

- Air renewal in buildings and industries.
- Maximum working temperature: 50°C.

UNDER REQUEST

- 3 speed fans.
- Impeller made of galvanized sheet.
- Rectangular outlet flange.

PERFORMANCE CURVE

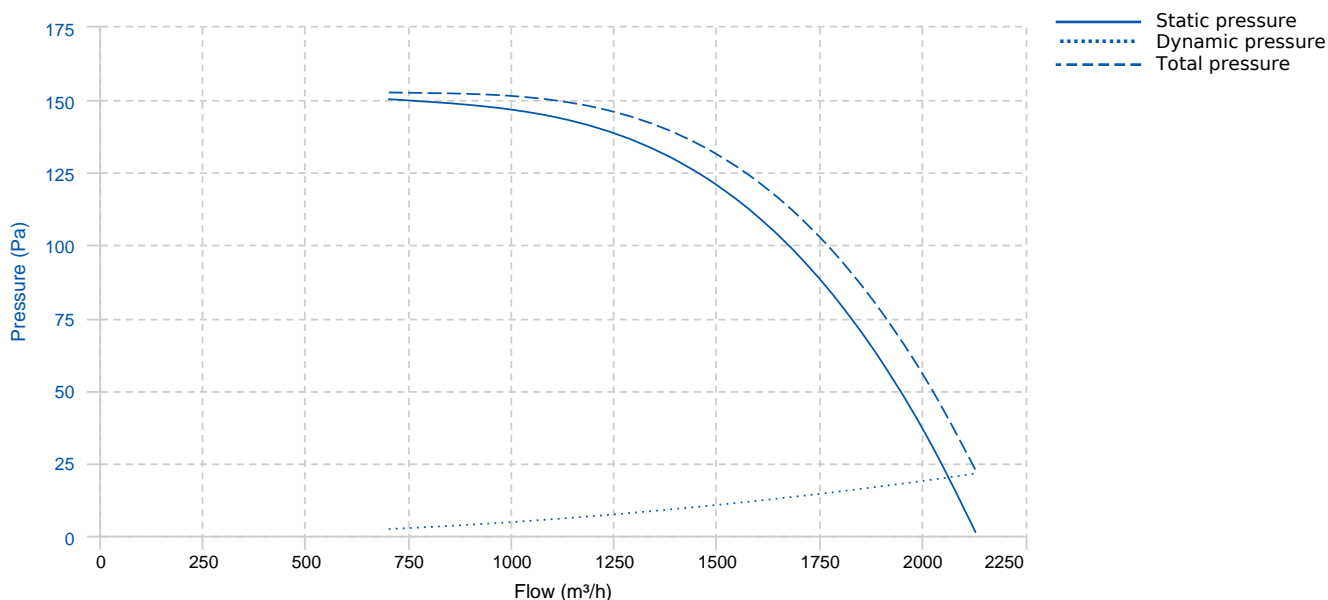

TECHNICAL DATA

Fan							
RPM	940	Approx. weight	33 kg	Max. Flow	2130 m ³ /h		
Motor							
Power	0,13 kW	RPM	940	Capacitor	6μF 400V	I max. (230V)	1,3 A
Size	STC80	Approx. weight	4.7 kg	Efficiency (%)	66.8 %	FP	0.99

ERP DATA

Fan data sheet		
Fan type	Unit for non-residential ventilation (LOT 6)	
Typology	Unidirectional	
reports.other	None	
Type of driver	None	
Motor power (kW)	0.13	
	Fan values	ERP Requirements 2018
Max. efficiency (%)	31.01	30.22
Effic. Heat recovery (%)	-	
Pabs (kW)	0.15	
Flow (m ³ /h)	1243.12	
Static pressure (Pa)	138.9	
Speed (m/s)	3.49	
SFP (W/m ³ /s)	433.15	

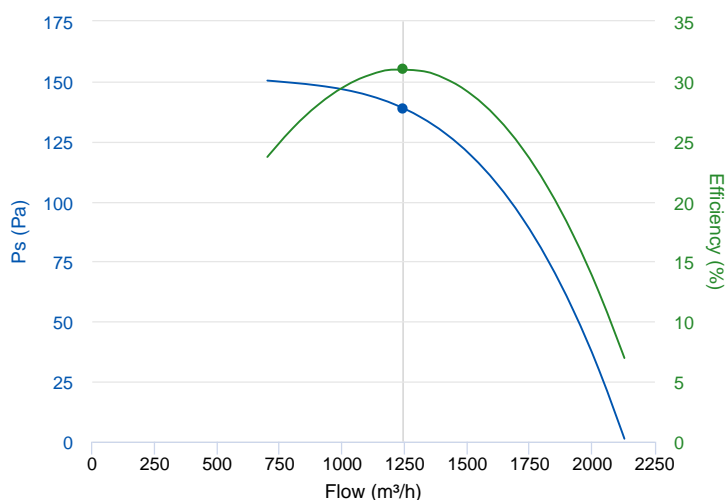

DIMENSIONS

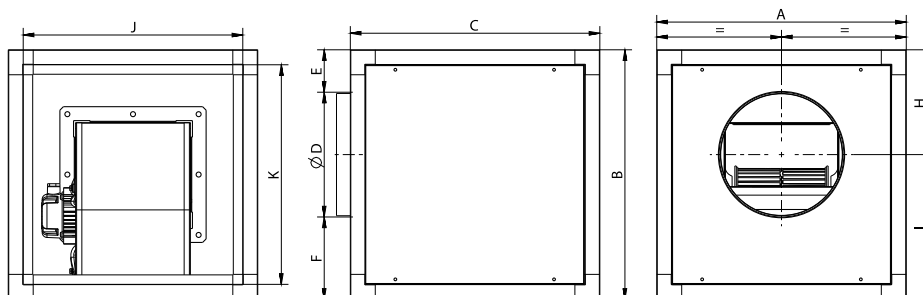

Dimensions (mm)

A	550	B	550	C	550	D	355	E	57,5
F	137,5	H	235	I	315	J	490	K	490

WIRING DIAGRAM

SINGLE PHASE MOTOR MOTOR MONOFÁSICO

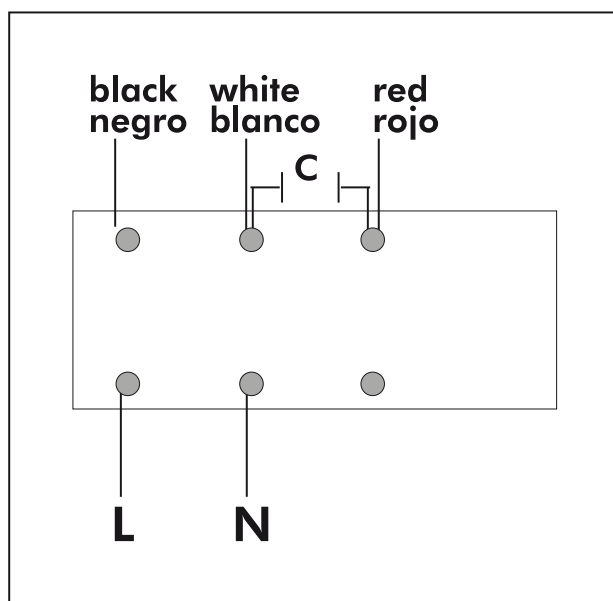

ACCESSORIES



MANUAL SINGLE PHASE SPEED CONTROLLER
REG 1,5A
REF: 960710015



SAFETY SWITCH
INT 25 3P A
REF: INT253PA

WEATHER PROTECTIVE ROOF FOR VENTILATION BOXES
TEJ BOX BD PLUS 9/9
 REF: 251281012

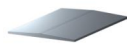

EXTERNAL BOX FILTER
BOX FILTER 550x550x300
 REF: 251288471



CELL FILTER WITH GALVANIZED FRAME
FILT ISO Coarse \geq 60% (488x440x48) PREFILTRO
MARCO CHAPA
 REF: FILTG04015



HIGH EFFICIENCY, RIGID AND COMPACT FILTER
FILT ePM1 \geq 50% (488x440x48) ALTA EFIC. PANEL
MINIPLGADO
 REF: FILTF07027



HIGH EFFICIENCY, RIGID AND COMPACT FILTER
FILT ePM1 \geq 80% (488x440x48) ALTA EFIC. PANEL
MINIPLGADO
 REF: FILTF09025



INLET/OUTLET ROUND COVER
TIAC BOX BD/BV PLUS 9/9 (Ø355)
 REF: 251281932R



CIRCULAR OUTDOOR FLANGE WITH BIRD GUARD
VISC Ø355
 REF: FX0050066



SPARE PARTS

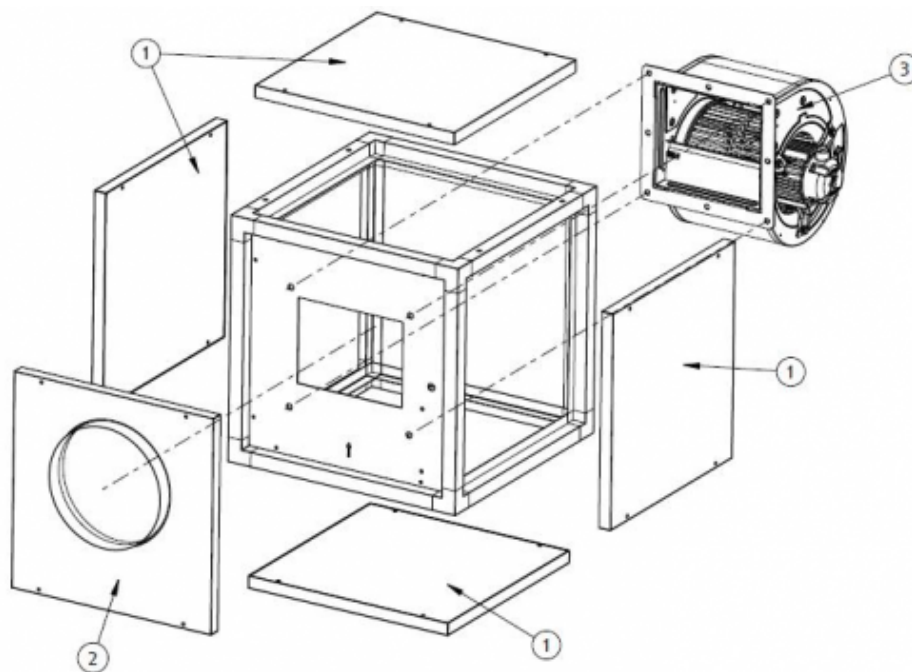

	Code	Model	Qty
1	R-251281931R	PANNEL BOX BD-BV PLUS 9/9	x4
2	R-251288901R	CIRCULAR CONNECTION BOX BD PLUS 9/9 (Ø355)	x1
3	251280261A002	FAN BD 9/9 M6 0,13kW+MBI	x1