

HJBM PLUS 25 M4 0,06kW (268263103)

GENERAL DATA



SQUARE WALL PLATE FAN, VARIABLE PITCH BLADES AND HIGH EFFICIENCY MOTOR

MANUFACTURING FEATURES

- Square plate made of galvanized steel sheet with polyester painting.
- Variable pitch angle polyamide impeller reinforced with fibreglass.
- Supplied with motor support and protection guard according to the UNE-EN 20-359-74 norm and the ROHS 2002/95/EC Directive (Restriction of the Use of Certain Hazardous Substances in Electrical and Electronic Equipments).
- High efficiency standard asynchronous squirrel-cage motor with IP-55 or IP-54 protection (wiring box IP-65) and Class F insulation. Manufactured with standard voltages: 230V 50Hz for the single phase motors and 230/400V 50Hz for the three phase motors.

APPLICATIONS

Designed for wall assembly, they are suitable for:

- Air renewal in buildings and industries.
- Maximum working temperature: single phase 50°C, three phase 60°C.

UNDER REQUEST

- Aluminium impeller.
- 60Hz fans.

PERFORMANCE CURVE

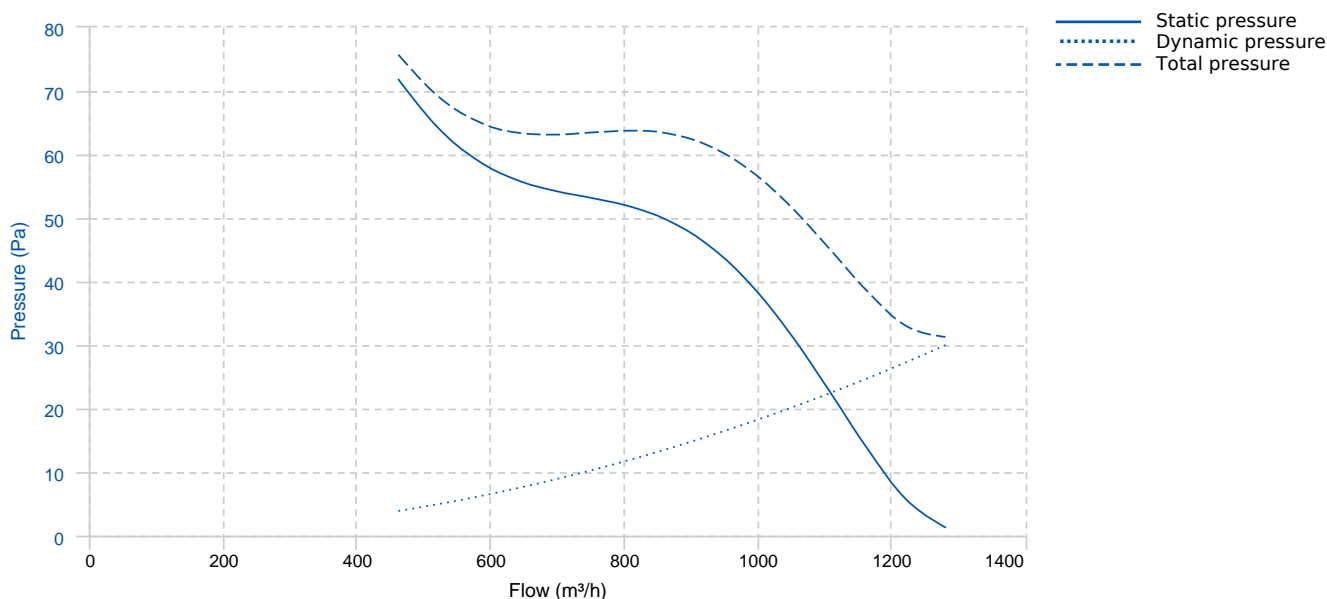

TECHNICAL DATA

| Fan | | | | | | | |
|-------|---------|----------------|--------|----------------|-----------|---------------|--------|
| RPM | 1400 | Approx. weight | 4 kg | Max. Flow | 1290 m³/h | | |
| Motor | | | | | | | |
| Power | 0,06 kW | RPM | 1400 | Capacitor | 4µF 450V | I max. (230V) | 0,58 A |
| Size | 56 | Approx. weight | 2.8 kg | Efficiency (%) | 50 % | FP | 0.9 |

DIMENSIONS

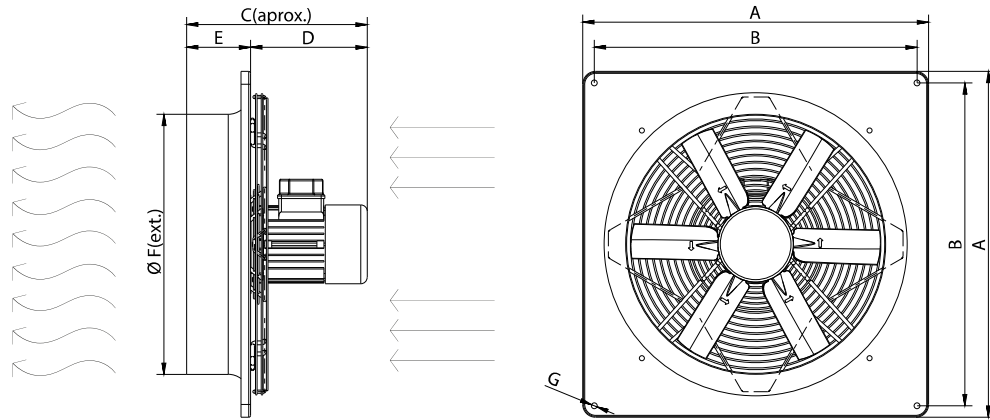

Dimensions (mm)

| | | | | | | | | | |
|----|-----|----|-----|---|-------|---|-------|---|----|
| A | 370 | B | 320 | C | 251,5 | D | 173,5 | E | 78 |
| ØF | 253 | ØG | 7 | | | | | | |

WIRING DIAGRAM

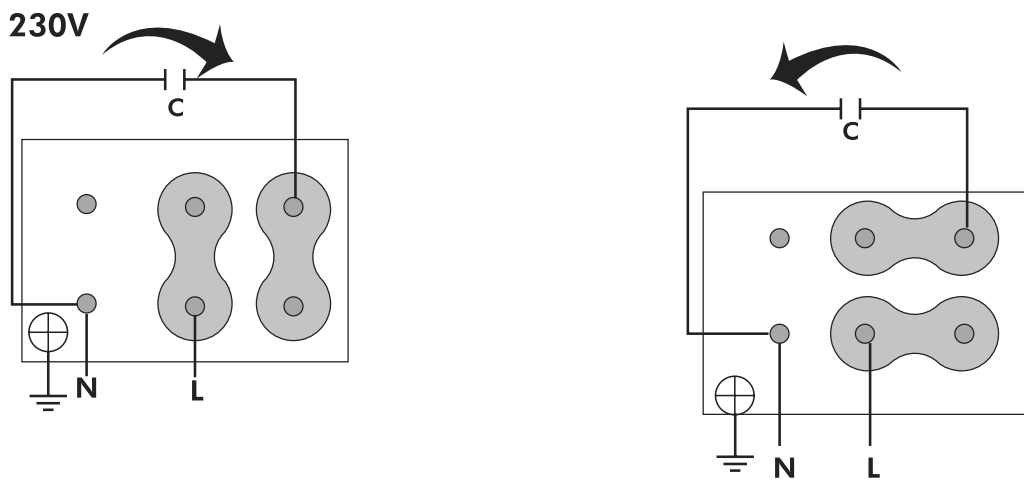

ACCESSORIES



SAFETY SWITCH
INT 25 3P A
REF: INT253PA



Outlet protection guard for axial fans
RPO 25
REF: 980000025



PLASTIC GRAVITY SHUTTER
PCP 25
REF: 963200105G

SPARE PARTS

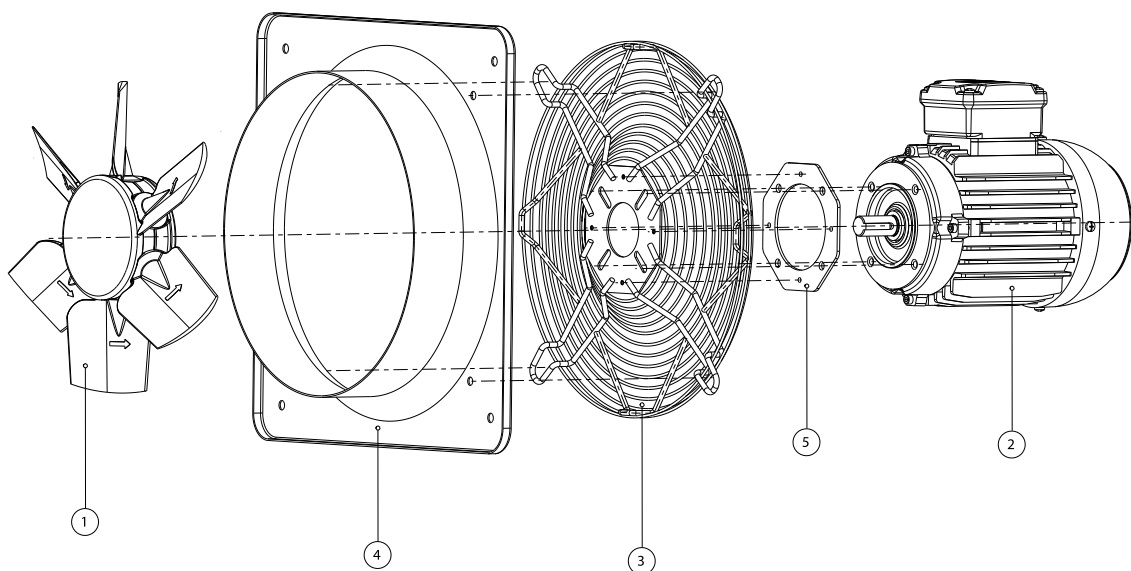

| | Code | Model | Qty |
|---|-----------------|-----------------------------------|-----|
| 1 | R-H25006040PSTD | IMPELLER 250:AP0:6 G40:D9 | x1 |
| 3 | R-268251902 | PROTECTION GRID HJBM25 | x1 |
| 4 | R-268251778A001 | FRAME HJBM25 | x1 |
| 5 | R-268251909 | SUPPORT MOTOR DISC HJBM25-30 T.56 | x1 |